



2021-2022

BENEFITS GUIDE

Non-California Of Counsel & Associates



quinn emanuel trial lawyers
quinn emanuel urquhart & sullivan, llp



TABLE OF CONTENTS

04

WELCOME!
ELIGIBILITY/ENROLLMENT/CHANGES

05

MEDICAL COVERAGE

06

DENTAL COVERAGE

07

VISION COVERAGE
YOUR COSTS FOR HEALTH COVERAGE

08

CIGNA SUPPORT/MY CIGNA

10

CIGNA VIRTUAL CARE

13

FLEXIBLE SPENDING ACCOUNTS

TABLE OF CONTENTS

15

TRANSPORTATION ALLOWANCE

17

401(K) PROFIT SHARING PROGRAM
TIME OFF

18

TIME OFF

19

LIFE & DISABILITY INSURANCE

20

LONG-TERM CARE INSURANCE

21

EMPLOYEE ASSISTANCE PROGRAM
TRAVEL ASSISTANCE

22

VOLUNTARY CRITICAL ILLNESS,
ACCIDENT & HOSPITAL INSURANCE

26

WORKERS COMP

27

QUESTIONS?

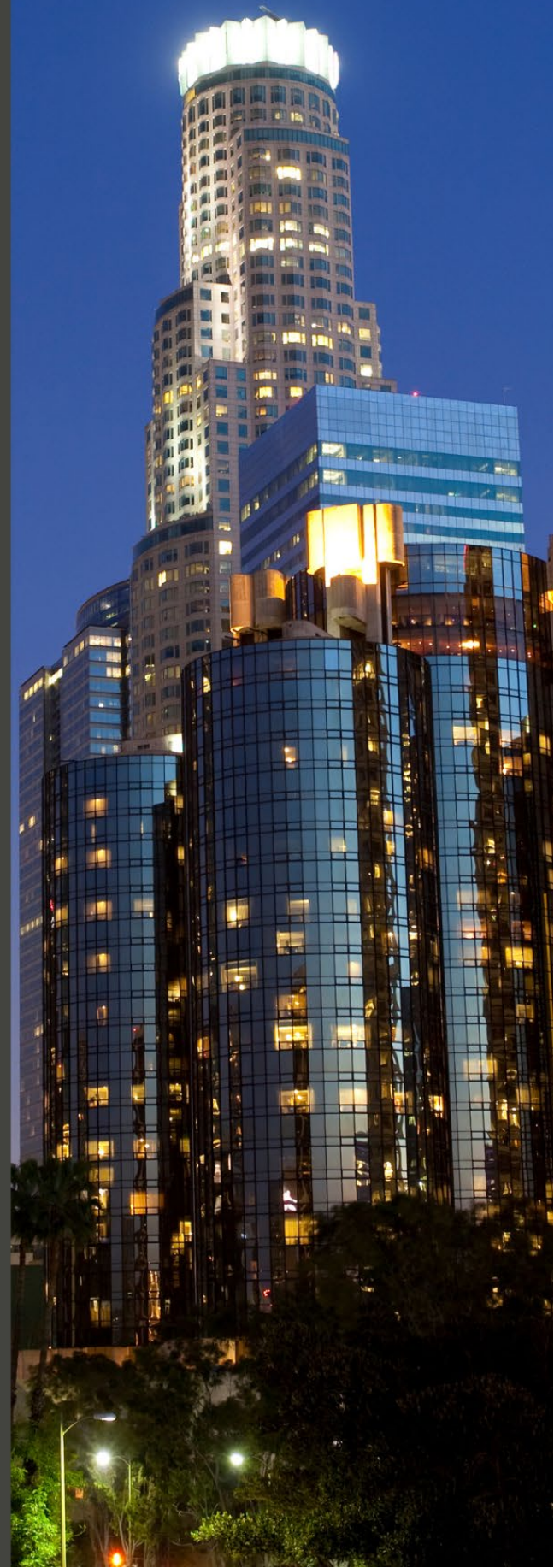

Welcome!

As part of the team at Quinn Emanuel Urquhart & Sullivan, LLP, you are offered a wide variety of employee benefits. In this guide, you'll find detailed information on the benefits available to you and your dependents. Review the following information and if you have any questions on your benefits, contact the Benefits Department or the appropriate carrier listed at the end of this guide.

Eligibility

You are eligible for Quinn Emanuel Urquhart & Sullivan, LLP medical benefits on your date of hire. All other benefits are effective on the first of the following month when you are an active full-time of associate/of counsel.

You may enroll your eligible dependents in the same plans you choose for yourself. Eligible dependents include your legal spouse or domestic partner (same sex or opposite sex) and your children up to age 26.

When to Enroll

You can enroll for coverage within 30 days of your eligibility date or during the annual open enrollment period.

If you are enrolling during the firm's annual open enrollment period, any changes you make will begin on September 1st.

If you don't enroll for coverage within 30 days of your eligibility date, you will not receive health coverage during the plan year, unless you have a qualified change in family status (see Making Changes for details).

Making Changes

The choices you make when you are first eligible are in effect for the remainder of the plan year, which ends on August 31. Once you enroll in coverage, you must wait until the next open enrollment period to change your benefits or add/remove coverage for dependents, unless you have a qualifying event in family status as defined by the IRS.

Here are some examples of Qualifying Events:

- Marriage, divorce, legal separation, annulment or death of spouse
- Birth, adoption or placement for adoption
- Change in your residence or workplace (if your benefit options change)
- Loss of other health coverage
- Change in your dependent's eligibility status because of age, student status or any similar circumstance

If you have a qualifying event, **you have 30 days** to make changes to your coverage.

Keep this in mind: Any change you make to your coverage must be consistent with the change in status.

Medical Coverage

For your convenience and flexibility, you have a choice of **several** Cigna medical plans. Review this table and choose the plan that's right for you and your dependents.

Plan Features	Cigna Open Access Plus (OAP) PPO		Cigna Choice Fund HDHP Open Access Plus PPO		Cigna Open Access-In HMO (All states except CA & FL)
	In-Network	Out-of-Network	In-Network	Out-of-Network	In-Network Only
Calendar Year Deductible	\$500 Individual \$1,000 Family	\$750 Individual \$1,500 Family	\$2,000 Individual \$4,000 Family	\$4,000 Individual \$8,000 Family	None
Calendar Year Out-of-Pocket Maximum	\$2,000 Individual \$4,000 Family	\$2,000 Individual \$4,000 Family	\$5,850 Individual \$11,700 Family	\$11,700 Individual \$23,400 Family	\$1,500 Individual \$3,000 Family
Primary Care Visit	\$25 copay	30% after deductible	20% after deductible	40% after deductible	\$25 copay
Specialist Visit	\$25 copay	30% after deductible	20% after deductible	40% after deductible	\$25 copay
Preventive Care	Covered in full	30% after deductible	Covered in full	Not covered	Covered in full
Emergency Room	\$100 copay (waived if admitted)		20% after deductible	20% after deductible	\$100 copay (waived if admitted)
Urgent Care	\$50 copay (waived if admitted)		20% after deductible	40% after deductible	\$50 copay (waived if admitted)
Outpatient Hospital Services	10% after deductible	30% after deductible	20% after deductible	40% after deductible	\$100/facility visit
Inpatient Hospital Services	\$250/admission, plus 10% after deductible	\$250/admission, plus 30% after deductible	20% after deductible	40% after deductible	\$240/admission
Outpatient Mental Health	\$25 copay	30% after deductible	20% after deductible	40% after deductible	\$25 copay
Inpatient Mental Health	\$250/admission, plus 10% after deductible	\$250/admission, plus 30% after deductible	20% after deductible	40% after deductible	\$240/admission
Prescription Drugs: Retail (up to a 30-day supply)					
Generic	\$15	30% after \$250	\$15	50% up to \$250	\$10
Brand Formulary	\$30	30% after \$250	\$30	50% up to \$250	\$20
Non-Formulary	\$45	30% after \$250	\$45	50% up to \$250	\$40
Prescription Drugs: Mail Order (up to a 90-day supply)					
Generic	\$30		\$30		\$20
Brand Formulary	\$60	Not covered	\$60	Not covered	\$40
Non-Formulary	\$90		\$90		\$80

This is only a brief summary of the plans. For more details, including limitations and exclusions, please review on the Intranet or contact the Benefits Department for a Summary Plan Description.

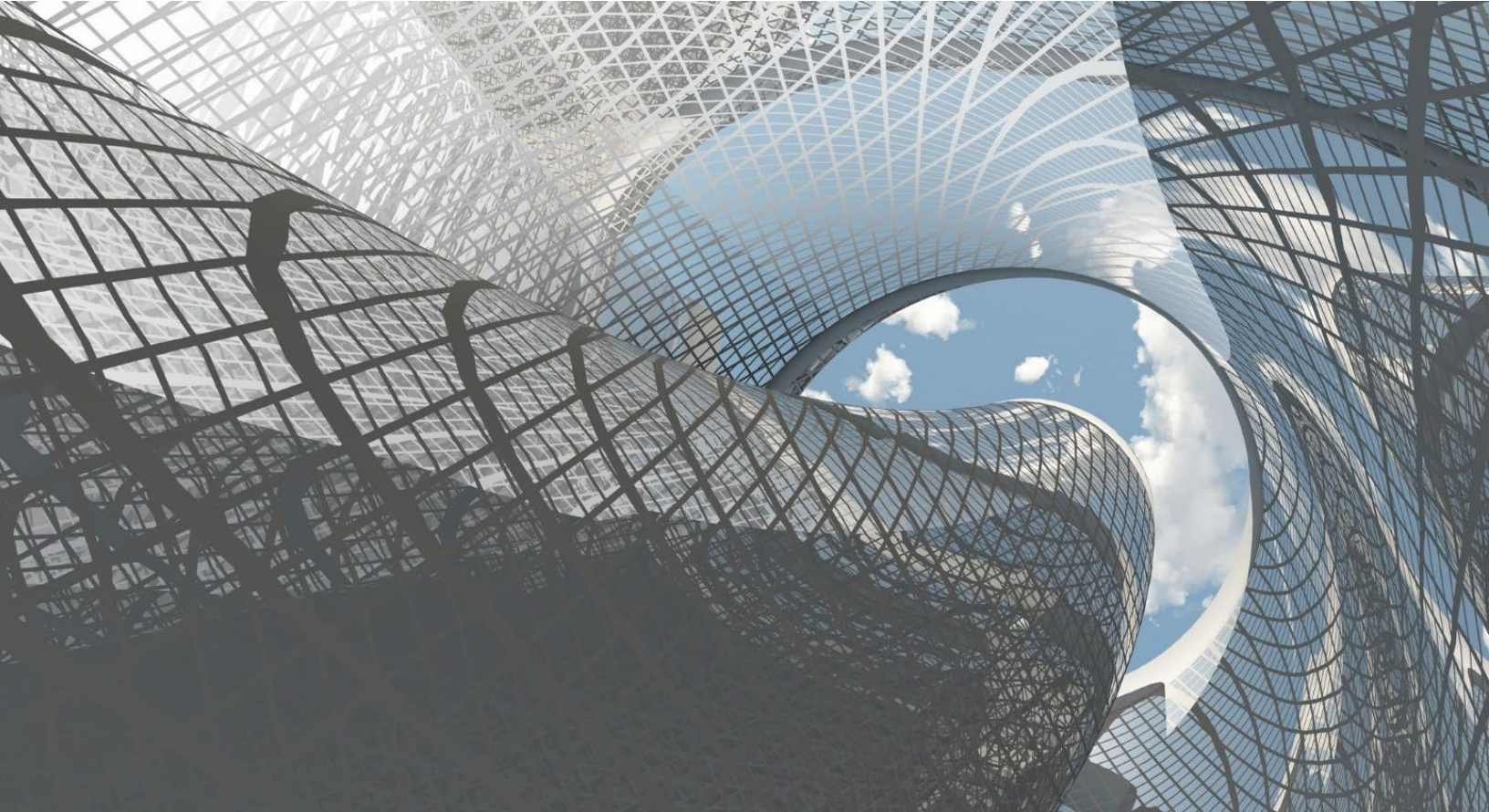

Dental Coverage

The Cigna dental plan covers a portion of approved dental procedures. Don't forget, visiting in-network dentists will help you save money on out-of-pocket expenses.

Plan Features	Total Cigna DPPO	
	In-Network	Out-of-Network*
Calendar Year Deductible (waived for Preventive Services)		\$50 per person \$150 per family
Calendar Year Maximum		\$5,000
Diagnostic and Preventive Services (e.g., X-rays, cleanings, exams)	Covered in full	Covered in full
Basic and Restorative Services (e.g., fillings, extractions, root canals)	80%	80%
Major Services (e.g., dentures, crowns, bridges)	50%	50%
Orthodontia (deductible waived)	50%	50%
Orthodontia Lifetime Maximum (dependent children to age 19)	\$1,000	\$1,000

*Note: If you visit an out-of-network provider, you are responsible for charges above usual, customary and reasonable (UCR) limits. In Texas, the dental plan meets the state's plan design mandate.

Vision Coverage

Protect your eyesight with EyeMed vision coverage. Visit in-network doctors to save on out-of-pocket expenses. You can find in-network providers at eyemed.com. EyeMed also offers the following perks just for being a member.

- Discounts on sunglasses: \$20 off, or \$50 off your purchase of \$200 or more at Sunglass Hut.

EyeMed Vision

Member Login:
eyemedvisioncare.com/member

Provider Locator:
<https://eyedoclocator.eyemedvisioncare.com/member/en/>
 Vision PPO Network Name:
"Insight"

PLAN FEATURES	EyeMed	
	In-Network	Out-of-Network
	You pay:	Plan reimburses you:
Exam – every 12 months	\$10	Up to \$40
Frames – every 12 months	No copay; \$190 allowance, 20% off balance over \$190	Up to \$133
Lenses – every 12 months		
Single Vision	\$10 copay	Up to \$30
Bifocal	\$10 copay	Up to \$50
Trifocal	\$10 copay	Up to \$70
Lenticular	\$10 copay	Up to \$70
Contact Lenses – every 12 months (in lieu of lenses and frames)	No copay; \$200 allowance	
Elective	15% off balance over \$200	Up to \$200
Medically Necessary	Covered in full	Up to \$210

Your Cost for Health Coverage

Your per paycheck payroll deductions for medical, dental, and vision coverage are shown in the table below:

Benefit Plan	Employee Only	Employee & Spouse	Employee & Child(ren)	Family
Medical				
Cigna Open Access Plus (PPO) - All Offices	\$0.00	\$298.46	\$220.40	\$518.86
Cigna HDHP (PPO) - All Offices	\$0.00	\$0.00	\$0.00	\$0.00
Cigna Open Access Plus IN (EPO) (Non-CA)	\$0.00	\$0.00	\$0.00	\$0.00
Dental				
Cigna DPPO – Non-CA	\$0.00	\$32.63	\$39.75	\$72.91
Vision				
EyeMed	\$3.44	\$6.53	\$6.87	\$10.10

Keep Track of Your Health with myCigna

Organize Your Health Plan Information with myCigna

myCigna.com is a simple way to personalize, organize, and access your important plan information. Register at [myCigna.com](https://mycigna.com) and login anytime to:

- Manage and track claims
- View ID Card information
- Find doctors and compare costs and quality ratings
- Review your coverage
- Track your account balances and deductibles
- Refill your prescription drugs online and check order status with Cigna Home Delivery Pharmacy

Get started today! Register at [myCigna.com](https://mycigna.com) or download the myCigna Mobile App for Apple, Android, Kindle Fire, or Blackberry.

What Matters Most? Your Health

Finding your way on your health journey can be challenging, but Cigna is here to help.

Cigna offers personalized support to meet you where you are on your health journey and get you where you need to be. You'll receive the information, tools, and inspiration you need to take greater charge of your health. It's easy, fun, and available at no additional cost to you!

- Take a simple, game-like online assessment that helps you identify your health goals
- Keep track of all your important health information—BMI, blood pressure, cholesterol, and more
- Discover popular health & wellness apps that work best for you—then track your progress
- Find fun new ways to better manage your health

Your health matters. Cigna is here to make your journey easier. Visit [myCigna.com](https://mycigna.com) from your desktop, smartphone, or tablet to get started.

MotivateMe Rewards Your Healthy Actions (plan participation is limited to employees, not dependents)

Being healthy doesn't happen overnight; it takes consistency in making good choices every day. To encourage you on your health journey, Cigna's MotivateMe program allows you to earn gift card rewards by participating in a variety of activities, including:

- Health assessment
- Annual preventive exams

Getting started is easy! Visit [myCigna.com](https://mycigna.com) and select Incentive Awards Program or call 800-244-6224 to:

- Review detailed instructions on how the MotivateMe program works
- View a list of eligible goals and matching rewards
- Check and track your completed goals and earned rewards

Make Smarter Medical Decisions with Cigna One Guide

Get the most out of your medical plan with Cigna One Guide. This service will assist you in making more informed choices, so you can stay healthy and save money. You can access Cigna One Guide through the myCigna mobile app or call 800-244-6224 to get answers to your health plan questions. Your One Guide team will help you:

- Understand your coverage and how it works
- Locate in-network doctors and facilities
- Connect with health coaches, pharmacists and more
- Receive dedicated one-on-one support for complex health issues
- Maximize your benefits and earn incentives
- Get cost estimates and service comparisons

Finding an In-Network Doctor Is Easy

Is your doctor or hospital in the Cigna network? Cigna's online directory makes it easy to find who (or what) you're looking for.

4 Simple Steps to Find a Doctor or Facility:

Step 1

Go to [Cigna.com](https://www.cigna.com) and click on "Find a Doctor" at the top of the screen. Then, under "Not a Cigna Customer Yet?" select "Plans through your employer or school." (If you're already a Cigna customer, log in to [myCigna.com](https://mycigna.com) or the myCigna® app to search your current network. To search other networks, use the [Cigna.com](https://www.cigna.com) directory.)

Step 2

Enter the geographic location you want to search.

Step 3

Optional - Select one of the plans offered by your employer during open enrollment.

Step 4

Enter a name, specialty or other search word. Click on one of our type ahead suggestions or the magnifying glass icon to see your results.

That's it! You can also refine your search results by distance, years in practice, specialty, languages spoken, and more.

Cigna Virtual Care

Convenient? Yes.
Costly? No.

WHEN LEAVING THE HOUSE IS EASIER SAID THAN DONE.

Get care whenever and wherever with medical and behavioral/mental health virtual care.

Medical virtual care for minor conditions costs less than ER or urgent care center visits, and maybe even less than an in-office primary care provider visit.

Life is demanding. It's hard to find time to take care of yourself and your family members as it is, never mind when one of you isn't feeling well. That's why your health plan through Cigna includes access to medical and behavioral/mental health virtual care.

Whether it's late at night and your doctor or therapist isn't available, or you just don't have the time or energy to leave the house, you can:

- Access care from anywhere via video or phone.
- Get medical virtual care 24/7/365 – even on weekends and holidays.
- Schedule a behavioral/mental health virtual care appointment online in minutes.
- Connect with quality board-certified doctors and pediatricians, as well as licensed counselors and psychiatrists.
- Have a prescription sent directly to your local pharmacy, if appropriate

Medical Virtual Care

Board-certified doctors and pediatricians can diagnose, treat and prescribe most medications for minor medical conditions, such as:

- Acne
- Allergies
- Asthma
- Bronchitis
- Cold and flu
- Constipation
- Diarrhea
- Earaches
- Fever
- Headache
- Infections
- Insect bites
- Joint aches
- Nausea
- Pink eye
- Rashes
- Respiratory infections
- Shingles
- Sinus infections
- Skin infections
- Sore throats
- Urinary tract infections

Behavioral/Mental Health Virtual Care

Licensed counselors and psychiatrists can diagnose, treat and prescribe most medications for nonemergency behavioral/mental health conditions, such as:

- Addictions
- Bipolar disorders
- Child/adolescent issues
- Depression
- Eating disorders
- Grief/loss
- Life changes
- Women’s Issues
- Men’s Issues
- Panic Disorders
- Parenting Issues
- Postpartum depression
- Relationship and marriage issues
- Stress
- Trauma/PTSD

Cigna Virtual Wellness Care – MDLIVE.

Wellness Screenings/Preventive Care can be done anywhere via phone, tablet or computer.

Virtual wellness screenings through MDLIVE are now available to all Cigna members. There is NO cost for the screening and lab work that is required. Your screening is provided by a board-certified MDLIVE provider. Simply make your appointment online through www.mycigna.com and go for a quick visit to a lab for your blood work and biometrics. The rest is completed online and via video or phone, wherever it’s most convenient for you.

It’s important that you proactively identify health issues such as high cholesterol and other risk factors before they become serious and costly. A summary of your preventive care visit will be provided to you for your records.

MDLIVE® = medical and behavioral/mental health virtual care.
888.726.3171

STEP 1	Complete your MDLIVE online health assessment.
STEP 2	Choose an in-network lab and schedule an appointment.**
STEP 3	Choose an MDLIVE provider and schedule your virtual visit.
STEP 4	Go to your lab appointment. You’ll receive a notification when the results are available in the MDLIVE customer portal.
STEP 5	Attend your virtual visit from anywhere via video or phone. After your visit, you’ll receive a summary of your screening results for your records.

Cigna Behavioral Health also provides access to video-based counseling through Cigna’s network of providers. To find a provider:

- Visit myCigna.com, go to “Find Care & Costs” and enter “Virtual counselor” under “Doctor by Type”
- Call the number on the back of your Cigna ID card 24/7

CIGNA BEHAVIORAL EXPANDS ITS NETWORK TO INCLUDE NEW VIRTUAL PROVIDERS IN CALIFORNIA.

Utilize your behavioral benefits to access care.

Talkspace

Available nationwide

Connect with a licensed therapist or psychiatrist online, by video or text using Talkspace, available for Cigna Behavioral customers, ages 13 and up.

To schedule an assessment, go to talkspace.com/Cigna.



Contact your Cigna representative for details and information.

Meru Health

Only available to customers in CA, CO and AZ

This 12-week virtual counseling program offers support for people suffering from depression, anxiety or burnout. The program includes live virtual counseling and private texting with licensed therapists, as well as an online peer support community and other educational resources for ages 18 and above.

To schedule your free screening session, go to meruhealth.com/Cigna

NOCD

Only available to customers in CA, MI and NC

Get personalized treatment for obsessive compulsive disorder (OCD) through virtual live therapy and app-based digital tools, including texting with a therapist. Available to Cigna Behavioral customers ages 6 and up.

For a free assessment, go to TreatMyOCD.com.

The health information line is here for you 24/7

It can be a fever in the middle of the night or a question about a popular medication. Whether you're looking for general information or have a specific health concern, the health information line is open 24 hours a day, seven days a week.

Dial 800.Cigna24 and you'll be connected with a nurse who is ready to help answer your health questions.

And there's more.

You can also listen to hundreds of podcasts in English and Spanish on almost any health topic to be better informed about your health. To listen:

- Select a topic and listen via livestream. Visit myCigna.com for more information.
- Call the health information line, follow the voice prompts, enter a code for the audio library, and you will be listening in seconds.



For more information, visit myCigna.com or call **800.Cigna24**

Flexible Spending Accounts (FSAs)

Save money for medical or dependent care expenses with pre-tax dollars deducted from your paycheck. With WageWorks, you can set aside up to \$2,500 in a Health Care FSA and up to \$5,000 in a Dependent Care FSA.

Important Rules to Keep in Mind

FSAs offer huge tax advantages, but these accounts are subject to strict IRS regulations:

- If you don't use the full amount in your FSAs by the end of the plan year, your unused account balance can be carried over and used to pay for health care expenses incurred in the first 2½ months of the next plan year.
- Once you enroll in the FSAs, you can't change your contribution amount during the year unless you experience a qualified status change such as marriage or birth of a child.
- You cannot transfer funds from one FSA to another.
- **This is a "Use it or Lose it" benefit. Claims must be submitted by March 31, 2022 for your 2021 expenses. No Exceptions!**

Helpful Hints

- Manage your FSA(s) online at [wageworks.com](https://www.wageworks.com)
- Download the WageWorks mobile app for iPhone or Android for quick access to your account including reimbursement forms and information.

Health Care FSA

With a Health Care FSA, you can use account funds for numerous health care related products and services – for yourself, your spouse, and your qualifying child or relative. IRS rules state that expenses reimbursed under your Health Care FSA may not be reimbursed under any other plan or program, and only qualified out-of-pocket expenses are eligible. Expenses must be incurred within the plan period.

Health Care FSA Expenses

The following are a few examples of eligible and ineligible Health Care FSA expenses:

Eligible Expenses	Ineligible Expenses
■ Acupuncture and chiropractic services	■ Cosmetic dental procedures
■ Birth control, condoms, contraceptives	■ Cosmetic prescription drugs, surgery, procedures
■ Co-pays, co-insurance, deductibles	■ Cosmetics, makeup, perfume
■ Dental exams, cleanings, fillings, orthodontia, qualified services	■ Deodorant, soap, shaving cream, razors
■ Eye exams, vision correction surgery, eyeglasses, contact lens solution	■ Diapers or diaper service
■ Insulin, diabetic supplies, test kits	■ Feminine hygiene products
■ Prescription drugs	■ Hair removal treatments and waxes
■ And much more...	■ Moisturizers and lotions

Health Care FSA Reimbursement

You must complete and submit a reimbursement form along with required documentation before a final determination is made. Examples of documentation include an explanation of benefits (EOB), itemized statement from the service provider, and itemized receipts. Access forms by logging in to your personal WageWorks account at wageworks.com.

Dependent Care FSA Expenses

Dependent care expenses must be for a qualifying individual who is:

- Your dependent child under the age of 13 and lives with you for more than half the year.
- Your spouse or other qualifying dependent who is physically or mentally incapable of self-care and lives with you for more than half the year.

A special note to divorced individuals: If you're divorced and are the custodial parent, your child is a qualifying individual even if you don't claim the child as a tax dependent. A divorced, non-custodial parent cannot be reimbursed under a Dependent Care FSA, even if the divorced, non-custodial parent claims the child as a tax dependent.

Eligible dependent care expenses for the Dependent Care FSA are those that allow you and your spouse (if you are married) to work or attend school full time. These services generally include day care, babysitters, most day camps, and caregivers for disabled dependents. These expenses must incur during the current plan year.

Dependent Care FSA Reimbursement Requirements

- A signed and dated Request for Reimbursement Form must accompany each reimbursement request. Access the form online from your personal WageWorks account at wageworks.com.
- If both the participant and provider certifications on the reimbursement form are completed and signed, additional documentation is not required.
- For reimbursement forms without the provider's signature, an itemized statement from the dependent care provider is required.
- Itemized statements should include the date of service, name and date of birth of dependent, itemization of charges, and provider's name, address, and Tax ID or Social Security Number.

Helpful Hint

Save your itemized receipts, EOBs, and other supporting documents along with copies of your reimbursement forms. Due to IRS Rules, WageWorks may ask you to verify your expenses.

Health Care and Dependent Care FSA Reimbursement Submission Process

WageWorks offers several options to submit reimbursement requests:

- Online at wageworks.com
- WageWorks mobile app for Apple and Android
- Fax reimbursement forms and documentation to the number on the form
- Mail reimbursement forms and copies of supporting documentation to the address listed on your form

For more detailed information, please see IRS FSA Publication 969 at <https://www.irs.gov/pub/irs-pdf/p969.pdf>.

Transportation Allowance

Commuter Account Benefits

With a WageWorks Commuter Account, each month you may elect to deduct an amount ranging from \$20 to \$265 from your paycheck on a pre-tax basis to use toward out-of-pocket transit, eligible vanpools, and qualified parking costs.

Transit Eligibility

Work-related transit expenses incurred by employees include vouchers, passes, tokens, and fare cards for transportation via bus, commercial vanpool, subway, train, ferry, and streetcar.

Eligible parking expenses incurred by employees include parking at or near work. Parking at or near a transportation service site, and park and ride expenses.

Ineligible expenses include car maintenance, carpools, gasoline, and tolls (E-ZPass, FasTrak, TollTag, ZipCash, etc.).

Special Rules for Commuter Expenses

- Unused funds are forfeited and cannot be “cashed out.”
- Qualified expenses include transportation expenses incurred between an employee’s residence and their workplace. Spouse or dependent expenses are not eligible.
- Unused amounts cannot be used to reimburse a participant after they are terminated.
- Expenses over the monthly maximum may not be carried over to the next coverage period.
- If you are an active participant, you may carry forward unused contributions to subsequent coverage periods.
- Reimbursement is limited to the amount contributed by the employee.

Helpful Hint

Manage your account online or on your mobile device with the WageWorks EZ Receipts mobile app. Learn more at wageworks.com/mycommute.



Transit Ordering and Reimbursement Process

Place your transit orders by logging in to your online WageWorks account at wageworks.com/mycommute. **Additional documentation is not required for transit expenses purchased online through your WageWorks account.**

Parking and Transit Reimbursement Documentation

Reimbursement requests must include standard documentation. Submit these required documents within 180 days after payment is made:

- Signed and dated reimbursement form with an itemized receipt showing the date of service and amount charged.
- A receipt is required unless receipts are unobtainable through the normal course of business. If a receipt isn't available, you should check the appropriate box under Supporting Documentation on the reimbursement form.

Reimbursement Submission Process

You have three ways to submit your reimbursement request:

- Online at wageworks.com/mycommute
- Fax reimbursement forms and documentation to the number on the form
- Mail reimbursement forms and copies of supporting documentation to the address listed on your form
- Orders must be in by the 10th of the month, for the following month.

401(k)

You are eligible to participate in a Merrill Lynch 401(k) plan after six months of employment on the first day of the next calendar quarter. Enrollments are effective on a quarterly basis. Once enrolled, you may drop contributions to zero at any time, but can only adjust up or down on the calendar quarter. An employer match is not available.

Merrill Lynch offers Benefits OnLine® to help plan for your future. Use this online resource to:

- Enroll in your 401(k) plan
- Check your balance
- Track investment performance
- Review transactions and account statements
- Chart your rate of return
- Change your elections and contribution rate
- Find tips and tools about investing in retirement

Visit benefits.ml.com (desktop) or m.benefits.ml.com (mobile) for more information.

Profit Sharing Plan

You are eligible to participate in the Profit Sharing Plan if you were hired July 1 or prior of the current year and have worked at least 1,000 hours. You must also be employed on December 31 to receive the contribution.

Employer contribution is a fixed percentage contingent upon the firm's profitability and discretion. Employees are fully vested upon funding.

The contribution is made into your 401(k) plan. If you are not participating in the voluntary portion of the 401(k), the firm will open an account in your name for the purposes of the Profit Sharing Plan.

Time Off

The following chart provides information on the time off available to active full-time employees.

Benefit	Time Off
Vacation	U.S. Associate and Of Counsel attorneys have unlimited vacation days, subject to case and business needs. As long as individual lawyers meet their obligations, they are eligible to take as much or as little vacation as desired.
Sick Leave	10 paid sick days per year. Sick days are pro-rated for the first year of employment and accrual methods vary by office.
Holidays	Holidays are paid. The holiday calendar is distributed annually.
Parental Leave - Primary Caregiver LOA	A Primary Caregiver is defined as someone who has primary responsibility for the immediate care of a child who has been added to the family through birth or adoption. Full time Associate and Of Counsel attorneys are entitled to up to 20 weeks Primary Caregiver leave. The leave payments will be reduced by any benefit amount available from State or City disability or paid leave programs, or the firm’s Short Term Disability plan, as applicable. The Benefits Department will assist attorneys in filing any necessary claim forms to receive these outside benefits. The leave will run concurrent with time off granted through the Family and Medical Leave Act (“FMLA Leave”) and any State or local job protection leaves of absence. Notice of an anticipated leave of absence should be given to the Benefits Department as soon as practical, and a doctor's statement is needed to estimate the start date for the leave. Lastly, the use of vacation time immediately trailing the paid leave is not permitted.
Parental Leave - Non-Primary Caregiver LOA	A Non-Primary Caregiver is defined as someone who has secondary responsibility for the care of a child who has been added to the family through birth or adoption. Full time Associate and Of Counsel attorneys are entitled to up to 8 weeks Non-Primary Caregiver leave. The leave payments will be reduced by any benefit amount available from State or City disability or paid leave programs, as applicable. The Benefits Department will assist attorneys in filing any necessary claim forms to receive these outside benefits. Notice of an anticipated leave of absence should be given to the Benefits Department as soon as practical, and a doctor's statement is needed to estimate the start date for the leave. It is intended that the 8 weeks available for Non-Primary Caregiver leave be taken in one lump time period and not on an intermittent basis, and within 12 months of the arrival of a new child. Additionally, the use of vacation time immediately trailing the paid leave is not permitted.
Family Building Benefit	The firm has partnered with New Life Agency to improve our family building benefit. New Life is the only insurance agency with exclusive insurance solutions serving the assisted reproductive community. The benefit provides Associates, Of Counsels and Partners, who have been with the firm for a year or more, a loan up to \$75,000 (lifetime maximum) toward infertility services. This loan will be forgiven, but subject to applicable taxes, if the employee/partner is still with the firm 12 months after the date of the last disbursement. Participants who leave the Firm for any reason, prior to 12 months following the last disbursement will require you to reimburse the firm for the full amount of the loan. Claims and/or requests for reimbursement are sent directly to New Life Agency. Contact Benefits for information on covered services.

Life and Disability Insurance

Basic Life and Accidental Death & Dismemberment (AD&D) Insurance

As an active employee, the firm provides \$60,000 of Basic Life and AD&D coverage at no cost to you.

Additional Voluntary Life Insurance

You may purchase additional Unum life insurance coverage for yourself at group rates. Consider costs such as funeral expenses, legal expenses, and general living expenses for your surviving family members when determining an appropriate amount of additional coverage.

Employee: You may choose amounts up to 5x your base salary in increments of \$10,000 to a maximum of \$500,000. The guaranteed issue amount for employees is \$200,000 during initial enrollment only. Unum's Lock-In Feature: If the minimum of \$10,000 is selected at initial enrollment, the benefit amount may be increased up to the full guaranteed issue amount during future open enrollments.

If you enroll in additional coverage for yourself, you may choose to elect coverage for your spouse and/or your child(ren) in the following amounts:

Spouse: \$5,000 increments up to 100% of additional employee life insurance. The guaranteed issue amount is \$25,000.

Child(ren): \$2,000 increments up to \$10,000.

Please note: Evidence of Insurability is required prior to approval for coverage above guaranteed issue amounts and for late entrants.

Short-Term Disability (STD)

You are automatically covered under the STD plan at no cost to you.

NY ONLY – New York Short Term Disability is mandated by New York Disability Benefit Law (DSL).

Long-Term Disability (LTD)

You're automatically covered under the LTD plan at no cost to you.

Unum LTD coverage will replace 60% of your base salary to a monthly maximum of \$10,000 if you are disabled for more than 90-days and are unable to work.

LTD benefits are offset with other sources of income, such as Social Security and workers' compensation.

Long Term Care Insurance

Unum Long Term Care insurance protects your income and assets in the event you need home care or assisted living for an extended illness or injury. The base plan is provided at no cost to you. Additional coverage for yourself and your family is available for an additional expense.

What Is Long Term Care?

It is the type of care you may need if — due to an accident or serious illness— you are unable to perform, without substantial assistance from another individual, two or more Activities of Daily Living such as:

- Eating
- Bathing
- Continenence
- Dressing
- Toileting
- Transferring

What Your Employer Is Offering

Associates

Long Term Care Insurance Base Plan:

- \$3,000/Month, 3 Years for: Nursing Facility & 70% Residential Care Facility/ 50% Home & Community-Based Care

No New Entrants after 4/1/22.

Associates and Of Counsel Benefit Summary:

<http://www.unuminfo.com/quinnemanuel/>

How Does This Coverage Help?

Long term care insurance offers benefits to help you pay for care provided by:

- Adult Day Care and Home Health Care
- Homemaker Services
- Hospice Services
- Personal Care and Respite Care
- Alzheimer’s Facility and Hospice Facility
- Nursing Facility and Residential Care Facility
- Rehabilitation Facility

Of Counsel

Long Term Care Insurance Base Plan:

- \$5,000/Month, 6 Years for: Nursing Facility & 70% Residential Care Facility/ 50% Home & Community-Based Care

Employee Assistance Program

The Employee Assistance Program (EAP) through Unum is available to you and your household family members 24 hours a day, seven days a week at (800) 854-1446. All calls are completely confidential and there is no cost to you for using the service.

The professionals at the EAP will help by assessing, advising, and recommending options to help you or your family members deal with problems. In addition to unlimited telephonic counseling, you are eligible for 3 face-to-face counseling sessions per incident per year.

The EAP can help with many issues including:

- Locating childcare or eldercare services
- Depression or grief
- Financial or legal problems
- Substance abuse
- Personal or work relationships
- Identity theft protection

Helpful Hint

Access useful resources online at unum.com/lifebalance

Travel Assistance

Whenever you travel 100 miles or more from home, make sure to bring the travel assistance phone number! Travel assistance helps both you and your family have access to medical and other important travel services 24 hours a day.

Use Unum travel assistance for quick access to:

- Emergency medical evacuation
- Prescription replacement assistance
- Care and transport of unattended minor children
- Emergency message service
- Emergency trauma counseling
- Referrals to Western-trained, English-speaking medical providers
- Passport replacement assistance

Contact Travel Assistance anywhere in the world, day or night:

Within U.S.: (800) 872-1414

Outside U.S.: +609-986-1234

Email: medservices@assistamerica.com



Accident Insurance

How does it work?

Accident Insurance can pay a set benefit amount based on the type of injury you have and the type of treatment you need. It covers accidents that occur on and off the job. And it includes a range of incidents, from common injuries to more serious events.



Why is this coverage so valuable?

- You're guaranteed base coverage, without answering health questions.
- The cost is conveniently deducted from your paycheck.
- It can help with out-of-pocket costs that your medical plan doesn't cover, like co-pays and deductibles.
- You can keep coverage if you change jobs or retire. You'll be billed directly.

Who can get coverage?

You	If you're actively at work*
Your spouse	Can get coverage as long as you have purchased coverage for yourself.
Your children	Dependent children from birth until their 26th birthday, regardless of marital or student status.

*Employees must be legally authorized to work in the United States and actively working at a U.S. location to receive coverage. Spouses and dependent children must reside in the United States to receive coverage.

How much does it cost?

Your monthly premium	Option 1
You	\$10.97
You and your spouse	\$18.92
You and your children	\$25.94
Family	\$33.89

Active employment: You are considered in active employment if, on the day you apply for coverage, you are being paid regularly for the required minimum 30 hours each week and you are performing the material and substantial duties of your regular occupation. Insurance coverage will be delayed if you are not in active employment because of an injury, sickness, temporary layoff, or leave of absence on the date that insurance would otherwise become effective. New employees have a day waiting period to be eligible for coverage. Please contact your plan administrator to confirm your eligibility date.

If enrolling, and eligible for Medicare (age 65+; or disabled) the Guide to Health Insurance for People with Medicare is available at www.medicare.gov/media/9486.

See Schedule of Benefits for a complete listing of what is covered.



Critical Illness Insurance

can pay money directly to you when you're diagnosed with certain serious illnesses.

How does it work?

If you're diagnosed with an illness that is covered by this insurance, you can receive a lump sum benefit payment. You can use the money however you want.

Why is this coverage so valuable?

- The money can help you pay out-of-pocket medical expenses, like co-pays and deductibles.
- You can use this coverage more than once. Even after you receive a payout for one illness, you're still covered for the remaining conditions and for the reoccurrence of any critical illness with the exception of skin cancer. The reoccurrence benefit pays 100% of your coverage amount. Diagnoses must be at least 180 days apart or the conditions can't be related to each other.

What's covered?

Critical Illnesses	
<ul style="list-style-type: none"> • Heart attack • Stroke • Major organ failure • End-stage kidney failure 	<ul style="list-style-type: none"> • Coronary artery disease Major (50%): Coronary artery bypass graft or valve replacement Minor (10%): Balloon angioplasty or stent placement

Cancer Conditions	
<ul style="list-style-type: none"> • Invasive cancer — all breast cancer is considered invasive 	<ul style="list-style-type: none"> • Non-invasive cancer (25%) • Skin cancer — \$500

Progressive Diseases	Supplemental Conditions
<ul style="list-style-type: none"> • Amyotrophic Lateral Sclerosis (ALS) • Dementia, including Alzheimer's disease • Multiple Sclerosis (MS) • Parkinson's disease 	<ul style="list-style-type: none"> • Loss of sight, hearing or speech • Benign brain tumor • Coma • Permanent Paralysis • Infectious Diseases (25%)

Your Unum plan pays a Be Well Benefit for one Be Well screening each year.

With Unum's Be Well Benefit, you and other covered family members can receive a valuable incentive for important tests and screenings. Many of these tests are routinely performed, so it's easy to take advantage of this benefit. **Your Critical Illness Be Well benefit is tied to the coverage amount you choose. For instance, if you choose a coverage amount of \$10,000, your Be Well benefit will be \$50. A coverage amount of \$30,000 will have a Be Well benefit of \$100.**

Why should I buy coverage now?

- It's more affordable when you buy it through your employer and the premiums are conveniently deducted from your paycheck.
- Coverage is portable. You may take the coverage with you if you leave the company or retire. You'll be billed at home.

Be Well Benefit	
Every year, each family member who has Critical Illness coverage can also receive a payment for getting a covered Be Well Benefit screening test, such as:	
<ul style="list-style-type: none"> • Annual exams by a physician include sports physicals, well-child visits, dental and vision exams • Screenings for cancer, including pap smear, colonoscopy • Cardiovascular functions screenings 	<ul style="list-style-type: none"> • Screenings for cholesterol and diabetes • Imaging studies, including chest X-ray, mammography • Immunizations including HPV, MMR, tetanus, influenza

Who can get coverage?

You:	Choose \$10,000, \$20,000 or \$30,000 of coverage with no medical questions if you apply during this enrollment.
Your spouse:	Spouses can get 50% of the employee coverage amount as long as you have purchased coverage for yourself.
Your children:	Children from live birth to age 26 are automatically covered at no extra cost. Their coverage amount is 50% of yours. They are covered for all the same illnesses plus these specific childhood conditions: cerebral palsy, cleft lip or palate, cystic fibrosis, Down syndrome and spina bifida. The diagnosis must occur after the child's coverage effective date.

Critical Illness Insurance benefit and cost

Monthly costs		
Age	Employee coverage: \$10,000 Spouse coverage: \$5,000 Be Well benefit: \$50	
	Employee	Spouse
under 25	\$3.44	\$2.64
25 - 29	\$4.14	\$2.99
30 - 34	\$5.14	\$3.49
35 - 39	\$6.44	\$4.14
40 - 44	\$8.54	\$5.19
45 - 49	\$11.74	\$6.79
50 - 54	\$16.34	\$9.09
55 - 59	\$22.44	\$12.14
60 - 64	\$31.84	\$16.84
65 - 69	\$45.84	\$23.84
70 - 74	\$67.94	\$34.89
75 - 79	\$93.44	\$47.64
80 - 84	\$122.54	\$62.19
85+	\$179.14	\$90.49

Monthly costs		
Age	Employee coverage: \$20,000 Spouse coverage: \$10,000 Be Well benefit: \$75	
	Employee	Spouse
under 25	\$6.88	\$5.28
25 - 29	\$8.28	\$5.98
30 - 34	\$10.28	\$6.98
35 - 39	\$12.88	\$8.28
40 - 44	\$17.08	\$10.38
45 - 49	\$23.48	\$13.58
50 - 54	\$32.68	\$18.18
55 - 59	\$44.88	\$24.28
60 - 64	\$63.68	\$33.68
65 - 69	\$91.68	\$47.68
70 - 74	\$135.88	\$69.78
75 - 79	\$186.88	\$95.28
80 - 84	\$245.08	\$124.38
85+	\$358.28	\$180.98

Monthly costs		
Age	Employee coverage: \$30,000 Spouse coverage: \$15,000 Be Well benefit: \$100	
	Employee	Spouse
under 25	\$10.32	\$7.92
25 - 29	\$12.42	\$8.97
30 - 34	\$15.42	\$10.47
35 - 39	\$19.32	\$12.42
40 - 44	\$25.62	\$15.57
45 - 49	\$35.22	\$20.37
50 - 54	\$49.02	\$27.27
55 - 59	\$67.32	\$36.42
60 - 64	\$95.52	\$50.52
65 - 69	\$137.52	\$71.52
70 - 74	\$203.82	\$104.67
75 - 79	\$280.32	\$142.92
80 - 84	\$367.62	\$186.57
85+	\$537.42	\$271.47



IT'S EASY TO FILE A CLAIM

You can receive a benefit for tests that are performed after your initial coverage date.

Follow these simple steps:

File your claim online with a one-time registration on **unum.com**, by mail or over the phone. Simply call 1-800-635-5597 to learn more.

You will need to provide the following:

- First and last names of the employee and claimant (the employee might not be the claimant)
- Employee's Social Security number or policy number
 - Name and date of the test
- Name of physician and the facility where the test was performed.



Each year, you can earn a valuable incentive just for taking care of your health. And so can each of your covered family members.

For more information, please contact your HR representative.



Hospital Insurance

How does it work?

Hospital Insurance helps covered employees and their families cope with the financial impacts of a hospitalization. You can receive benefits when you're admitted to the hospital for a covered accident, illness or childbirth.

Why is this coverage so valuable?

- The money is paid directly to you — not to a hospital or care provider. The money can also help you pay the out-of-pocket expenses your medical plan may not cover, such as co-insurance, co-pays and deductibles.
- You get affordable rates when you buy this coverage at work.
- The cost is conveniently deducted from your paycheck.
- The benefits in this plan are compatible with a Health Savings Account (HSA).
- You may take the coverage with you if you leave the company or retire, without having to answer new health questions. You'll be billed directly.

Hospital		
Hospital Admission	Payable for a maximum of 1 day per year	\$1,000
ICU Admission	Payable for a maximum of 1 day per year	\$1,000
Hospital Daily Stay	Payable per day up to 365 days	\$100
ICU Daily Stay	Payable per day up to 30 days	\$100

Hospital Insurance can pay benefits that help you with the costs of a covered hospital visit.

Who can get coverage?

You:	If you're actively at work.
Your spouse:	Can get coverage as long as you have purchased coverage for yourself.
Your children:	Dependent children newborn until their 26th birthday, regardless of marital or student status

Employee must purchase coverage for themselves in order to purchase spouse or child coverage. Employees must be legally authorized to work in the United States and actively working at a U.S. location to receive coverage. Spouses and dependent children must reside in the United States to receive coverage.

How much does it cost?

Your Monthly Premium	
You	\$10.15
You and your spouse	20.40
You and your children	\$14.67
Family	4.93

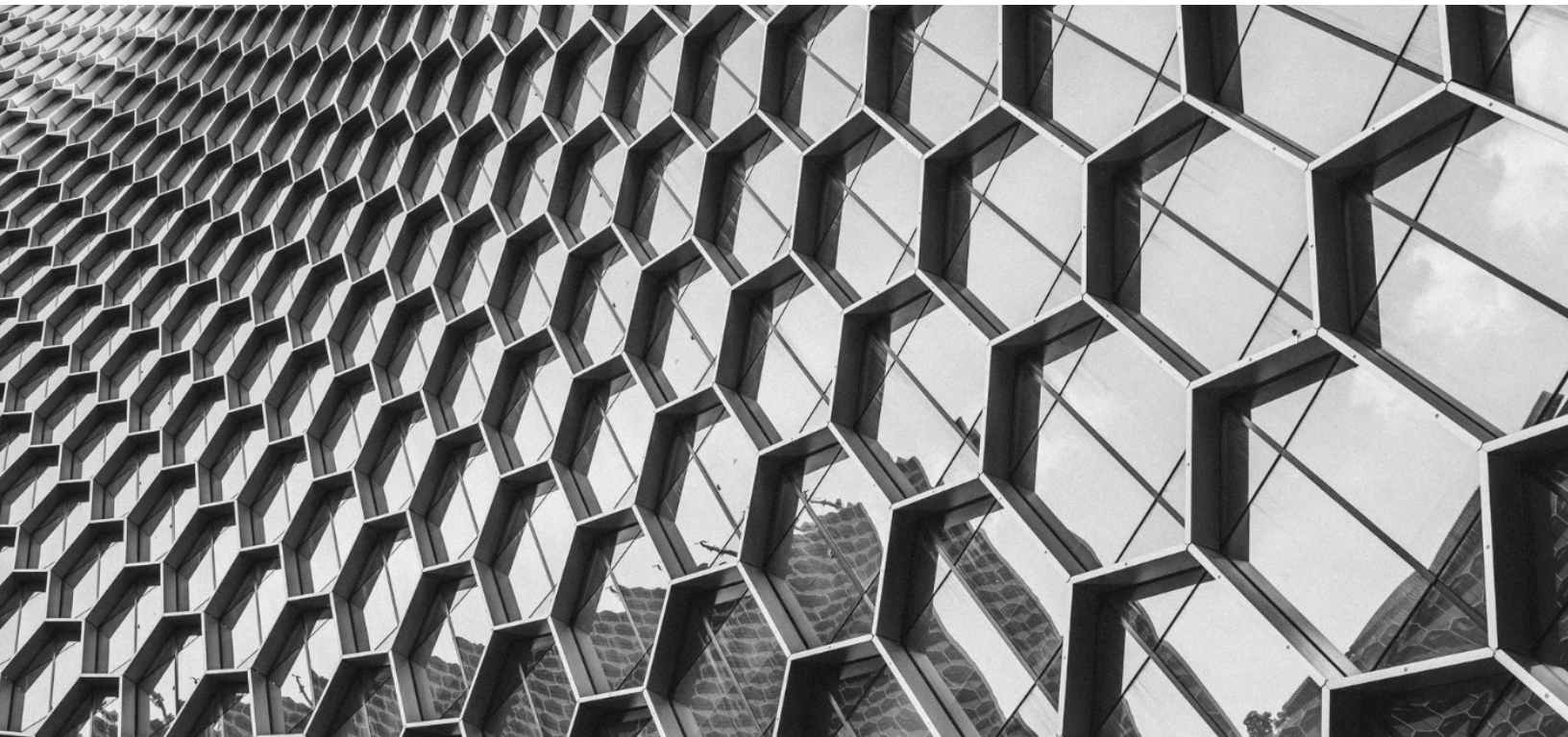

Workers' Compensation Benefits

At time of injury, contact your office manager. Below are the required forms and Medical Network information.

DWC-1 Employee Claim Form

This form must be completed by every employee at the time they report a Workers' Compensation injury. The form is located at the DWC website (updated in 2010) or by clicking here:

<http://www.dir.ca.gov/dwc/forms/ClaimForm2010.pdf>

Time of Hire Pamphlet

This provides information to new employees about Workers' Compensation and includes the Pre-Designation of Primary Physician and Notice of Personal Chiropractor or Personal Acupuncturist forms:

<https://www.dir.ca.gov/dwc/DWCPamphlets/TimeOfHirePamphlet.pdf>

Workers' Compensation Carrier

CHUBB Group of Insurance/
Federal Insurance Company
555 S. Flower Street, 3RD Floor
Los Angeles, CA 90071
Phone: 213-612-0880
Policy Effective Date: 04/01

Medical Provider Network (MPN)

Corvel MPN
1100 Town & Country Road, Suite 400
Orange, CA 92868
MPN Assistance: 800.966.5307
MPN Lookup Must Select Workers' Compensation
Network: <http://www.corvel.com/ppo-lookup/>

Questions? Ask Here

All Summary Plan Descriptions, Claim Forms, and Enrollment Forms can be found on the Intranet.

Benefit	Contact	Telephone	Website or Email
General Information	QE Benefits Department: Kathy Starr	(213) 443-3637	intranet.quinnemanuel.com Email: benefitsdepartment@quinnemanuel.com Email: kathystarr@quinnemanuel.com
Medical	Cigna	(800) 244-6224	mycigna.com
Telehealth Services	Cigna	MDLive for Cigna 888-726-3171	mdliveforcigna.com Mobile app search: MDLive for Cigna
Dental	Cigna	(800) 244-6224	mycigna.com
Vision	EyeMed	(888) 439-3633	Member Login: eyemedvisioncare.com/member Provider Locator: https://eyedoclocator.eyemedvisioncare.com/member/en/
Flexible Spending Accounts (FSAs)	WageWorks	(877) 864-9549	wageworks.com
401(k)	Merrill Lynch	(800) 228-4015	benefits.ml.com (desktop)
Basic Life and AD&D	Unum	(800) Ask-UNUM	Email: askunum@unum.com
Voluntary Life	Unum	(800) Ask-UNUM	Email: askunum@unum.com
Long-Term Disability	Unum	(800) Ask-UNUM	Email: askunum@unum.com
Long Term Care Insurance	Unum	(800) Ask-UNUM	http://www.unuminfo.com/quinnemanuel/
Voluntary Accident	Unum	(800) 635-5597	getbenefitsmart.com Email: askunum@unum.com
Voluntary Critical Illness	Unum	(800) 635-5597	getbenefitsmart.com Email: askunum@unum.com
Employee Assistance Program (EAP)	Unum	(800) 854-1446	unum.com/lifebalance
Commuter Account	WageWorks	(877) 924-3967	wageworks.com/mycommute
Travel Assistance	Unum	U.S. (800) 872-1414 Outside U.S. +(609)986-1234	Email: medservices@assistamerica.com

This communication highlights your Quinn Emanuel Urquhart & Sullivan, LLP benefit plans. Your actual rights and benefits are governed by the official plan documents. If any discrepancy exists between this communication and the official plan documents, the plan documents will prevail. Quinn Emanuel Urquhart & Sullivan, LLP reserves the right to change any benefit plan without notice. Benefits are not a guarantee of employment.